



19 PETERS CLOSE PRESTWOOD BUCKINGHAMSHIRE HP16 9ET

A three bedroom, mid-terrace, town-house located in the heart of the village with a lovely outlook across well-tended allotments and convenient for local schools and amenities. The property has huge scope for alteration and reconfiguring to suit buyers' requirements.

Entrance Hall | Integral Garage | Study/Bedroom 4 | Sitting room | Dining Room | Kitchen | Family Bathroom | Enclosed Rear Garden | Off Street Parking

There are very few townhouses in Prestwood and they compare very favourably with more traditional three bedroom, semi-detached and terraced houses. In the main they have more spacious and more useable accommodation, the bonus being the extra space on the ground floor. This property is no exception. The house is neatly and tidily presented but would benefit from general updating. There is ample opportunity to re-imagine the space and design a house with a Wow factor.

On the ground floor there is an internal door to the large, single, integral garage plus a downstairs cloakroom and study/spare bedroom and a door to the garden.

Stairs near the front door lead up into the sitting room which is well proportioned; being roughly square, with windows running across the front which makes the whole room light and bright. To the rear there is a separate dining room, with views over the allotments, and the kitchen. This is fitted with a range of cream units with space for slot in appliances and also overlooks the allotments.

Stairs from the sitting room lead up to the second floor landing and to two double and one single bedroom and a four piece bathroom.

Outside, the rear gardens are level and enclosed and have a gate leading to the allotments. To the front there is brick paver off-street parking for at least two vehicles.

DIRECTIONS: From our offices in Prestwood follow the High Street towards Great Missenden. Peters Close is the first on the left and 19 can be found on the far side on the right indicated by a For Sale board.

Price... £380,000 Freehold



AMENITIES

Prestwood village centre has an excellent range of day to day facilities available including a variety of local shops, ie Butchers, Bakers, Newsagents, Post Office, Chemist, Florist and Supermarkets, together with Doctors' and Dentists' surgeries. There are local schools for children up to the age of 11 years. For secondary education, Prestwood lies in the catchment area for the Amersham/Chesham Grammar Schools and The Royal Grammar School for Boys in High Wycombe. The Misbourne School in Great Missenden also offers schooling for 11-18 year olds. Private schools close by include The Gateway in Great Missenden and Pipers Corner for girls in Great Kingshill. Nearby Great Missenden also offers a main line rail link into Central London which is ideal for the commuter. For more extensive requirements both High Wycombe and Amersham are approximately 4/5 miles from Prestwood.

DISTANCES (All distances are approximate)

Great Missenden 1.5 miles | Amersham 5 miles | High Wycombe 4 miles

SCHOOL CATCHMENTS (2020/21)

Prestwood Infant & Junior Schools
Boys' Grammar – Chesham, Dr Challoner's and The Royal Grammar School
Girls' Grammar – Chesham, Dr Challoner's High School
Upper School/All ability – The Misbourne School

ADDITIONAL INFORMATION

Mains water, electricity, gas
central heating

Council Tax Band E

EPC Band D

TO VIEW THIS PROPERTY, PLEASE CONTACT

Wye Country 120 High Street,
Prestwood, Bucks HP16 9HD

Tel: 01494 868000

prestwood@wyecountry.co.uk

www.wyecountry.co.uk



The floor plan is provided for guidance only and should not be scaled and may have slight inaccuracies.

Ground Floor

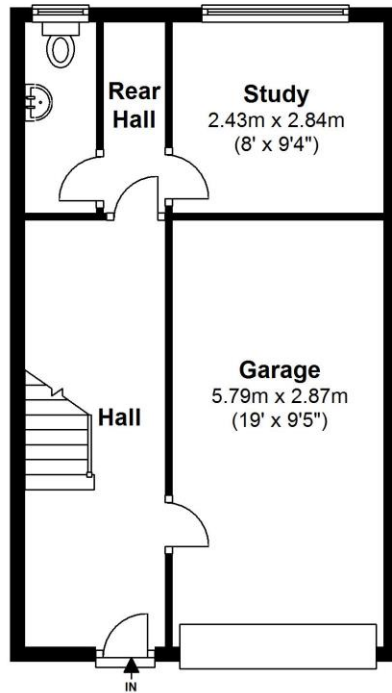

First Floor

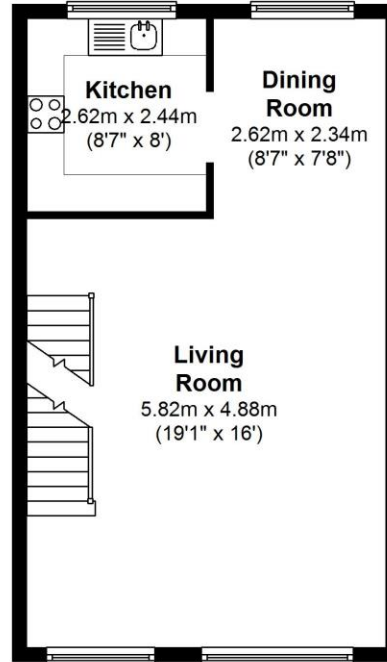

Second Floor

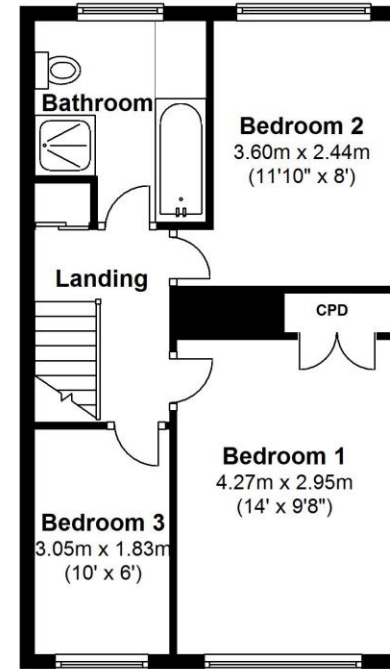

Whilst these particulars are believed to be correct they are not guaranteed by the vendor or the vendor's agents "The Wye Partnership" and neither does any person have any authority to make or give any representation or warranty on their behalf. Prospective purchasers must satisfy themselves by inspection or otherwise as to the correctness of each statement contained in these particulars. All measurements are approximate and the particulars do not constitute, or form part of an offer or a contract.